

TACTILE

	Page No.
Surface Mount	
3.5 x 6mm	562
6 x 6mm	564
6 x 6mm washable.	566
12 x 12mm	568
Through Hole	
3.5 x 6mm	563
6 x 6mm	565
6 x 6mm washable.	566
6 x 6mm radial taped.	567
12 x 12mm	569
Switch Caps	570

DUAL IN-LINE

Surface Mount	
Top slide actuator, low profile IC package .	571
Piano key actuator, low profile	571
Through Hole	
Top slide actuator, low profile IC package .	572
Piano key actuator, low profile	572
Top slide actuator	573
Piano key actuator.	573

ROTARY, ENCODED

Surface Mount	
BCD, 8 & 10 position	574
Hexadecimal	574
Through Hole	
BCD, 8 & 10 position,	
Screwdriver & finger adjust	575
Hexadecimal,	
Screwdriver & finger adjust	575

MICROSWITCHES

Microminiature	576
Sub-miniature, Solder & PCB Terminals.	576

DIPTRONICS type DTSM-3



A range of miniature 3.5 x 6mm size surface mount tactile switches offering a choice of button length, together with an option of packaging method.

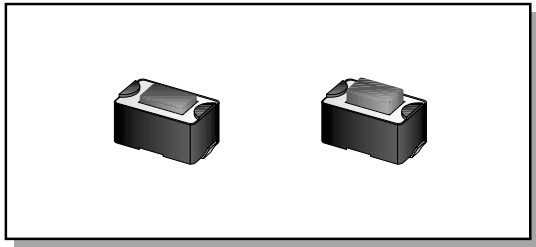

- ◆ Miniature **3.5 x 6mm** size
- ◆ **Surface mount**
- ◆ Positive 'click' action and tactile feedback
- ◆ Choice of button length
- ◆ SPNO momentary contacts
- ◆ 2 terminal mounting
- ◆ Supplied in sticks or taped & reeled

Specification

Contact arrangement single pole, single throw 2 terminal normally open, momentary action
 Contact rating..... 50mA, 12Vdc
 Contact resistance..... 100mΩ max.
 Operating force 160 ±50gf (brown button)

Travel..... 0.25mm
 Insulation resistance 100MΩ min. at 500Vdc
 Dielectric strength 250Vac for 1 minute
 Operating temp. range -25°C to +70°C
 Life expectancy 50,000 cycles min. (electrical)

Choice of button length and packaging method.

STICK

Manf. Part No.	Button Length (L)	Anglia Order Code
DTSM-31N-B	4.3	ST031
DTSM-32N-B	5.0	ST032

TAPE & REEL

Manf. Part No.	Button Length (L)	Anglia Order Code
DTSM-31N-T/R	4.3	ST031R
DTSM-32N-T/R	5.0	ST032R

N.B. These switches are not suitable for PCB washing.

Dimensions (mm)

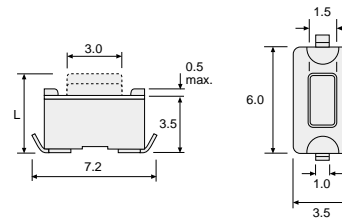

Pad Pattern

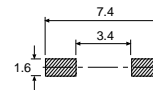

Circuit Diagram



Packaging

TAPE : 16mm wide, 8mm pitch REEL : 330mm dia.

NEW

DIPTRONICS type DTS-3

A range of miniature 3.5 x 6mm size pcb mounting tactile switches offering a choice of button length.

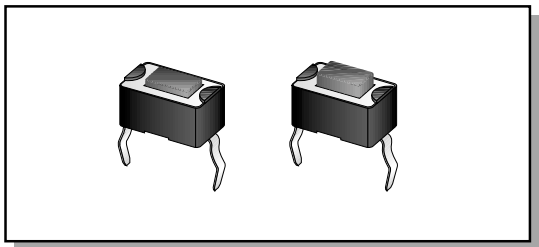

- ◆ Miniature **3.5 x 6mm** size
- ◆ Positive 'click' action and tactile feedback
- ◆ Choice of button length
- ◆ SPNO momentary contacts
- ◆ 2 terminal mounting

Specification

Contact arrangement..... single pole, single throw 2 terminal
normally open, momentary action
Contact rating 50mA, 12Vdc
Contact resistance..... 100mΩ max.
Operating force..... 160 ±50gf (brown button)

Travel 0.25mm
Insulation resistance..... 100MΩ min. at 500Vdc
Dielectric strength..... 250Vac for 1 minute
Operating temp. range -25°C to +70°C
Life expectancy..... 50,000 cycles min. (electrical)

Choice of button length. Supplied in tubes.

Manf. Part No.	Button Length (L)	Anglia Order Code
DTS-31N-B	4.3	448031
DTS-32N-B	5.0	448032

Dimensions (mm)

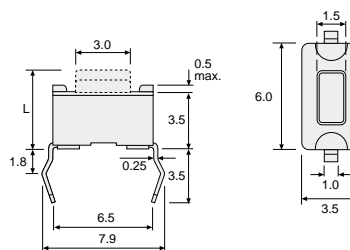

Footprint

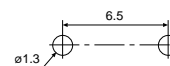

N.B. These switches are not suitable for PCB washing.

Circuit diagram





DIPTRONICS type DTSM-6

A range of 6 x 6mm size surface mount tactile switches offering a choice of button style and/or length and operating force, together with an option of packaging method. High reliability with up to 500,000 cycle electrical life expectancy.

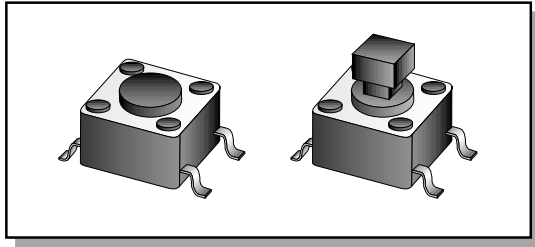

- ◆ 6 x 6mm size
- ◆ Surface mount
- ◆ Positive 'click' action and tactile feedback
- ◆ Choice of button style, length and operating force
- ◆ SPNO momentary contacts
- ◆ 4 terminal mounting
- ◆ High reliability, longer life
- ◆ Supplied in sticks or taped & reeled

Specification

Contact arrangement single pole, single throw 4 terminal normally open, momentary action
 Contact rating 50mA, 12Vdc
 Contact resistance 100mΩ max.
 Operating force 100 ±50gf (black button)
 160 ±50gf (brown button)
 260 ±50gf (red button)

Travel 0.25mm
 Insulation resistance 100MΩ min. at 500Vdc
 Dielectric strength 250Vac for 1 minute
 Operating temp. range -25°C to +70°C
 Life expectancy 100 & 160gf = 500,000 cycles min. (electrical)
 260gf = 50,000 cycles min. (electrical)

Choice of button style, length, operating force and packaging method.

STICK

Manf. Part No.	Button Style	Button Length	Operating Force (gf)
DTSM-61K-B	Round	4.3(L)	100
DTSM-61N-B	Round	4.3(L)	160
DTSM-61R-B	Round	4.3(L)	260
DTSM-62K-B	Round	5.0(L)	100
DTSM-62N-B	Round	5.0(L)	160
DTSM-62R-B	Round	5.0(L)	260
DTSM-63K-B	Round	7.0(L)	100
DTSM-63N-B	Round	7.0(L)	160
DTSM-63R-B	Round	7.0(L)	260
DTSM-644K-B	Square	7.3(L1)	100
DTSM-644N-B	Square	7.3(L1)	160
DTSM-644R-B	Square	7.3(L1)	260



Anglia
Order Code
ST062
ST062B
ST062C
ST063
ST063B
ST063C
ST064
ST064B
ST064C
ST061
ST061B
ST061C

TAPE & REEL

Manf. Part No.	Button Style	Button Length	Operating Force (gf)
DTSM-61K-T/R	Round	4.3(L)	100
DTSM-61N-T/R	Round	4.3(L)	160
DTSM-61R-T/R	Round	4.3(L)	260
DTSM-62K-T/R	Round	5.0(L)	100
DTSM-62N-T/R	Round	5.0(L)	160
DTSM-62R-T/R	Round	5.0(L)	260



Anglia
Order Code
ST062R
ST062BR
ST062CR
ST063R
ST063BR
ST063CR

N.B. These switches are not suitable for PCB washing, see page 566 for washable types.

TACTILE SWITCH CAPS
 Round or Square
 suitable for square button switches
 see page 570

Dimensions (mm)

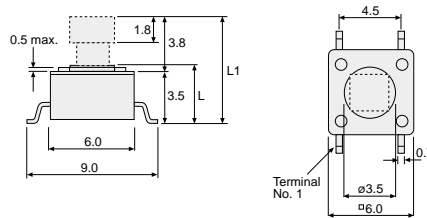

Pad Pattern

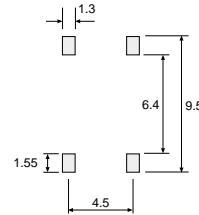

Circuit Diagram

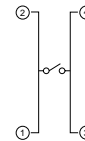

Packaging

TAPE : 16mm wide, 12mm pitch REEL : 330mm dia.





DIPTRONICS type DTS-6/DTSA-6

A range of 6 x 6mm size pcb mounting tactile switches offering a choice of button style, length and operating force, together with an option of mounting position. High reliability with up to 500,000 cycle electrical life expectancy.

Specification

Contact arrangement.....	single pole, single throw 4 terminal normally open, momentary action	Travel	0.25mm
Contact rating	50mA, 12Vdc	Insulation resistance.....	100MΩ min. at 500Vdc
Contact resistance.....	100mΩ max.	Dielectric strength.....	250Vac for 1 minute
Operating force.....	70 ±50gf (blue button) 100 ±50gf (black button) 160 ±50gf (brown button) 260 ±50gf (red button)	Operating temp. range.....	-25°C to +70°C
		Life expectancy.....	70 to 160gf = 500,000 cycles min. (electrical) 260gf = 50,000 cycles min. (electrical)

- ◆ 6 x 6mm size
- ◆ Positive 'click' action and tactile feedback
- ◆ Choice of button style, length and operating force.
- ◆ SPNO momentary contacts
- ◆ 4 terminal mounting
- ◆ Established footprint
- ◆ Mounting position option
- ◆ High reliability, longer life

ROUND BUTTON - type DTS-6/DTSA-6

Choice of button length, operating force and mounting position.

VERTICAL

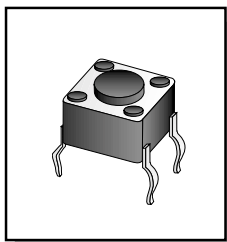

Manf. Part No.	Button Length (L)	Operating Force (gf)	Anglia Order Code
DTS-61K	4.3	100	448062
DTS-61N	4.3	160	448062B
DTS-61R	4.3	260	448062C
DTS-62K	5.0	100	448063
DTS-62N	5.0	160	448063B
DTS-62R	5.0	260	448063C
DTS-63K	7.0	100	448064
DTS-63N	7.0	160	448064B
DTS-63R	7.0	260	448064C
DTS-65K	9.5	100	448065
DTS-65N	9.5	160	448065B
DTS-65R	9.5	260	448065C
DTS-66K	13	100	448067
DTS-66N	13	160	448067B
DTS-66R	13	260	448067C

RIGHT ANGLE

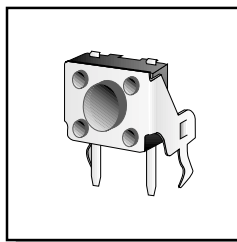

Manf. Part No.	Button Length (L)	Operating Force (gf)	Anglia Order Code
DTSA-62K	3.85	100	448071
DTSA-63K	5.85	100	448073
DTSA-65K	8.35	100	448072

SQUARE BUTTON - type DTS-64/DTSA-64

Choice of operating force and mounting position. Button 'shoulder' designed to accommodate actuator springs for tamper switch applications.

VERTICAL

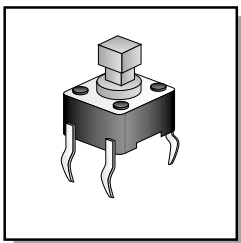

Manf. Part No.	Operating Force (gf)	Anglia Order Code
DTS-644U	70	448061
DTS-644K	100	448061A

RIGHT ANGLE

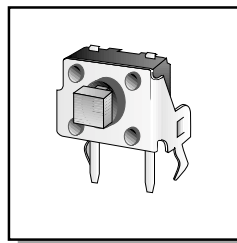

Manf. Part No.	Operating Force (gf)	Anglia Order Code
DTSA-644U	70	448070
DTSA-644K	100	448070A

TACTILE SWITCH CAPS
Round or Square
suitable for square button switches
see page 570

N.B. These switches are not suitable for PCB washing, see page 566 for washable types.

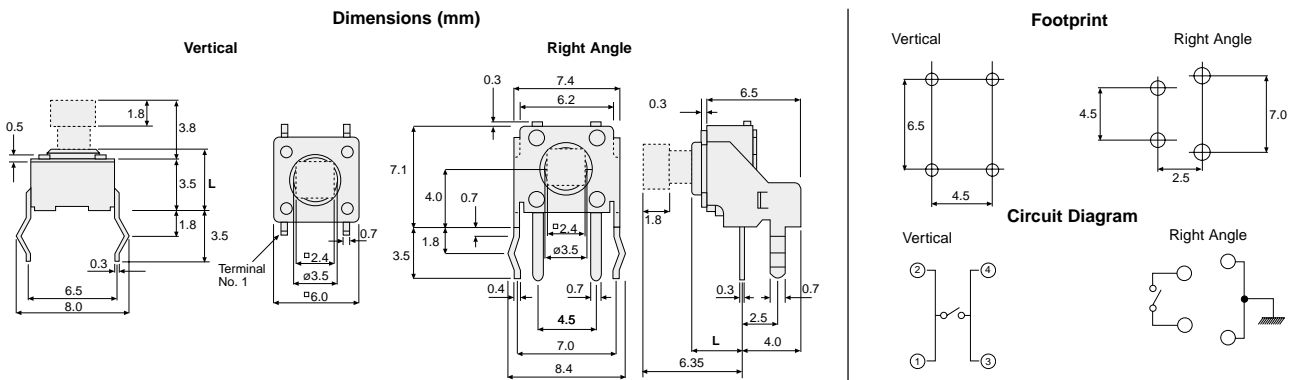

DIPTRONICS type DTSJW, DTSMW, DTSHW-6



A range of surface mount and through hole washable tactile switches with a round button. Choice of button length and operating force. Lead form and packaging option on surface mount parts. Designed to meet the increasing demand for sealed tactile switches to withstand pcb washing.

Specification

Contact arrangement..... single pole, single throw 4 terminal normally open, momentary action
 Contact rating..... 50mA, 12Vdc
 Contact resistance..... 100mΩ max.
 Operating force..... 160gf ±50gf (silver button, L = 2.3) (brown button, L = 3.1) 180gf ±50gf (brown button, L = 3.8) 260gf ±50gf (red button)

Travel..... 0.25mm
 Insulation resistance..... 100MΩ min. at 500Vdc
 Dielectric strength..... 250Vac for 1 minute
 Operating temp. range..... -25°C to +70°C
 Life expectancy..... 100,000 cycles min. (electrical) for DTS*W - 66N, 68S 500,000 cycles min. (electrical) for DTS*W - 69N, 69R

- ◆ 6 x 6mm size
- ◆ Sealed construction suitable for pcb washing
- ◆ SMD or through hole
- ◆ Positive 'click' action and tactile feedback
- ◆ Choice of button length and operating force
- ◆ SPNO momentary contacts
- ◆ 4 terminal mounting

SURFACE MOUNT type DTSJW & DTSMW



Choice of button length, operating force, lead form and packaging method.

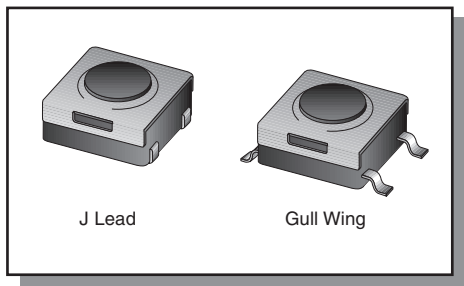

Button Length (L)	Operating Force (gf)	Manf. Part No.	STICK		TAPE & REEL	
			Anglia Order Code	Manf. Part No.	Anglia Order Code	
J Lead						
2.3(flush)	160	DTSJW-68S-B	ST068JW	DTSJW-68S-T/R		ST068JWR
3.1	160	DTSJW-66N-B	ST066JW	DTSJW-66N-T/R		ST066JWR
3.8	180	DTSJW-69N-B	ST069JW	DTSJW-69N-T/R		ST069JWR
3.8	260	DTSJW-69R-B	ST069CJW	DTSJW-69R-T/R		ST069CJWR
Gull Wing						
2.3(flush)	160	DTSMW-68S-B	ST068W	DTSMW-68S-T/R		ST068WR
3.1	160	DTSMW-66N-B	ST066W	DTSMW-66N-T/R		ST066WR
3.8	180	DTSMW-69N-B	ST069W	DTSMW-69N-T/R		ST069WR
3.8	260	DTSMW-69R-B	ST069CW	DTSMW-69R-T/R		ST069CWR

THROUGH HOLE type DTSHW

Choice of button length and operating force. Supplied in tubes.

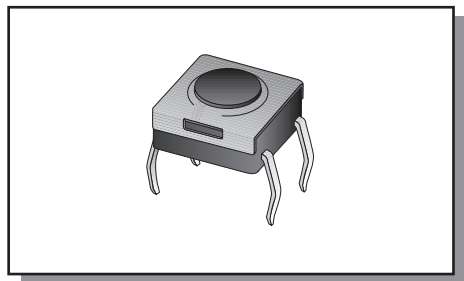

Button Length (L)	Operating Force (gf)	Manf. Part No.	Anglia Order Code
2.3(flush)	160	DTSHW-68S-B	448068W
3.1	160	DTSHW-66N-B	448066W
3.8	180	DTSHW-69N-B	448069W
3.8	260	DTSHW-69R-B	448069CW

Dimensions (mm)

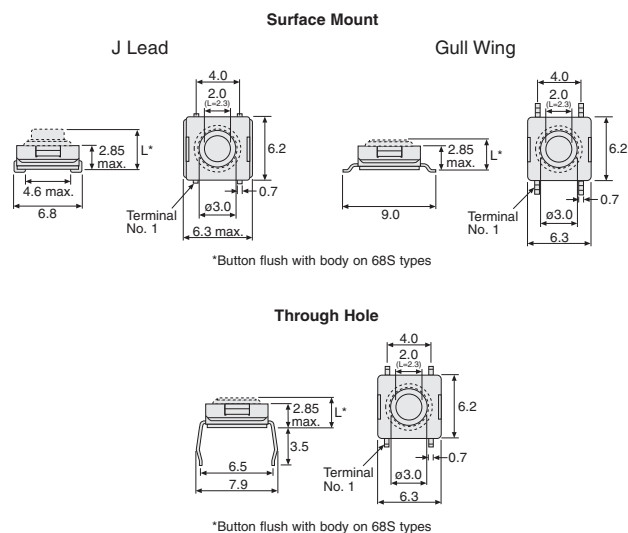

Pad Pattern (surface mount)

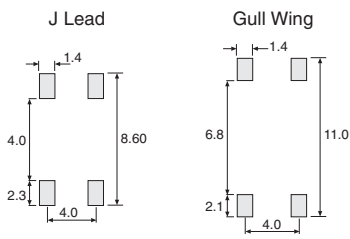

Footprint (through hole)

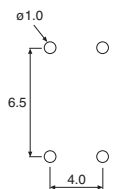

Circuit Diagram (all types)

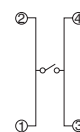

Packaging (surface mount)

TAPE : 16mm wide, 8mm pitch

REEL : 330mm dia.





DIPTRONICS type DTST-6

A range of 6 x 6mm size tactile switches supplied in a radial taped package and offering a choice of button style. The switches feature high reliability with 500,000 cycle electrical life expectancy.

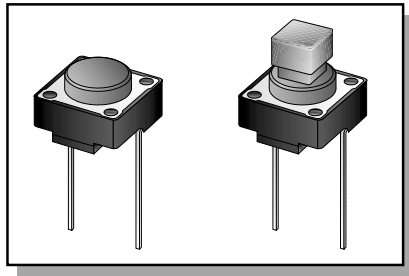

- ◆ 6 x 6mm size
- ◆ Radial taped
- ◆ Positive 'click' action and tactile feedback
- ◆ Choice of button style
- ◆ SPNO momentary contacts
- ◆ 2 terminal mounting
- ◆ High reliability, longer life
- ◆ Supplied taped & boxed

Specification

Contact arrangement	single pole, single throw 2 terminal normally open, momentary action	Travel.....	0.25mm
Contact rating.....	50mA, 12Vdc	Insulation resistance	100MΩ min. at 500Vdc
Contact resistance.....	100mΩ max.	Dielectric strength.....	250Vac for 1 minute
Operating force	100 ±50gf (black button)	Operating temp. range	-25°C to +70°C
		Life expectancy	500,000 cycles min. (electrical)

Choice of button style.

TAPE & BOX

Manf. Part No.	Button Style	Button Length	Anglia OrderCode
DTST-61K	Round	4.3 (L)	448062T
DTST-644K	Square	7.3 (L1)	448061AT

TACTILE SWITCH CAPS
 Round or Square
 suitable for square button switches
 see page 570

Dimensions (mm)

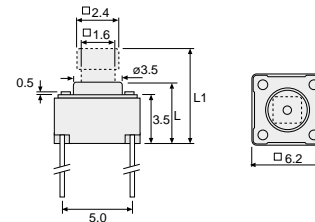

Footprint

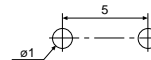

Circuit Diagram



Packaging

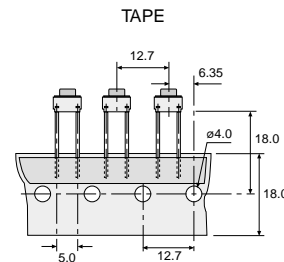

DIPTRONICS type DTSM-2



A range of 12 x 12mm size surface mount tactile switches offering a choice of button style and packaging method.
 High reliability with 500,000 cycle electrical life expectancy.

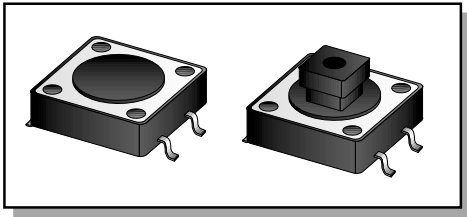

- ◆ 12 x 12mm size
- ◆ Surface mount
- ◆ Positive 'click' action and tactile feedback
- ◆ Choice of button style
- ◆ SPNO momentary contacts
- ◆ 4 terminal mounting
- ◆ High reliability, longer life
- ◆ Supplied in sticks or taped & reeled

Specification

Contact arrangement single pole, single throw 4 terminal normally open, momentary action
 Contact rating 50mA, 12Vdc
 Contact resistance 100mΩ max.
 Operating force 160 ±50gf (brown button)

Travel 0.35mm
 Insulation resistance 100MΩ min. at 500Vdc
 Dielectric strength 250Vac for 1 minute
 Operating temp. range -25°C to +70°C
 Life expectancy 500,000 cycles min. (electrical)

Choice of button style and packaging method.

STICK

Manf. Part No.	Button Style	Button Length	Anglia Order Code
DTSM-21N-B	Round	4.3 (L)	ST122
DTSM-24N-B	Square	7.3 (L1)	ST121

TAPE & REEL

Manf. Part No.	Button Style	Button Length	Anglia Order Code
DTSM-21N-T/R	Round	4.3 (L)	ST122R
DTSM-24N-T/R	Square	7.3 (L1)	ST121R

TACTILE SWITCH CAPS
 Round or Square
 suitable for square button switches
 see page 570

Dimensions (mm)

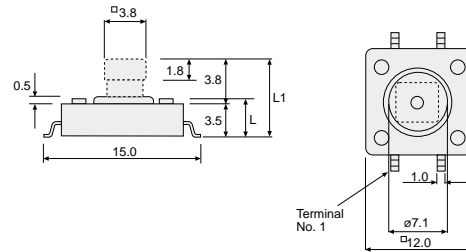

Pad pattern

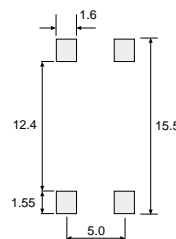

Circuit Diagram

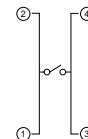

Packaging

TAPE : 24mm wide, 16mm pitch REEL : 330mm dia.



DIPTRONICS type DTS-2

A range of 12 x 12mm size pcb mounting tactile switches offering a choice of button style and operating force.
High reliability with up to 500,000 cycle life expectancy.

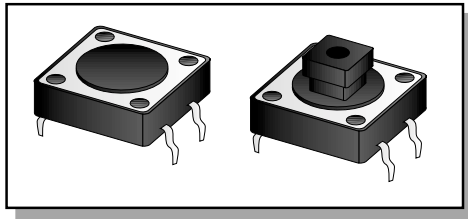

- ◆ 12 x 12mm size
- ◆ Positive 'click' action and tactile feedback
- ◆ Choice of button style and operating force
- ◆ SPNO momentary contacts
- ◆ 4 terminal mounting
- ◆ **High reliability, longer life**
- ◆ Established footprint

Specification

Contact arrangement..... single pole, single throw 4 terminal normally open, momentary action
 Contact rating 50mA, 12Vdc
 Contact resistance..... 100mΩ max.
 Operating force..... 160 ±50gf (brown button)
 260 ±50gf (red button)

Travel 0.35mm
 Insulation resistance..... 100MΩ min. at 500Vdc
 Dielectric strength..... 250Vac for 1 minute
 Operating temp. range..... -25°C to +70°C
 Life expectancy..... 160gf = 500,000 cycles min. (electrical)
 260gf = 50,000 cycles min. (electrical)

Choice of button style and operating force.

Manf. Part No.	Button Length	Operating Force	Anglia Order Code
ROUND BUTTON			
DTS-21N	4.3 (L)	160gf	448122
DTS-21R	4.3 (L)	260gf	448122B
SQUARE BUTTON			
DTS-24N	7.3 (L1)	160gf	448121
DTS-24R	7.3 (L1)	260gf	448121B

Dimensions (mm)

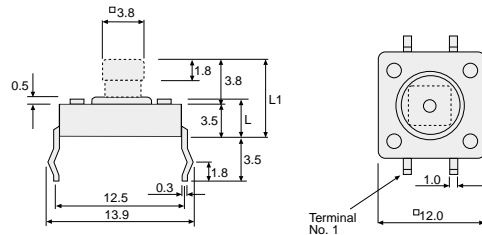

Footprint

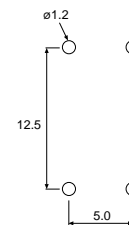

Circuit Diagram

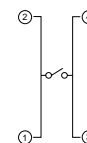

TACTILE SWITCH CAPS
 Round or Square
 suitable for square button switches
 see page 570

A range of moulded caps for use with 6 x 6mm & 12 x 12mm **square button** tactile switches. Available in round or square style, each with a choice of 6 different colours.

CAPS for 6 x 6mm tactile switches

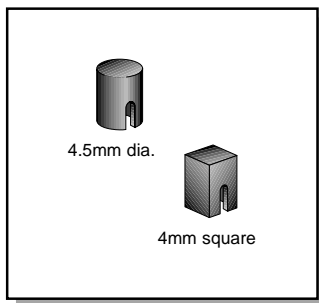

Style	Round - 4.5mm dia.		Square - 4 x 4mm	
Designed to fit	6 x 6mm square button tactile switches			
Suitable switches*	448061/A, 448061AT, 448070/A & ST061/B/C			
Colour	Manf. Part No.	Anglia Order Code	Manf. Part No.	Anglia Order Code
Black	KTSC-62K	448820	KTSC-61K	448810
Red	KTSC-62R	448822	KTSC-61R	448812
Yellow	KTSC-62Y	448824	KTSC-61Y	448814
Blue	KTSC-62B	448825	KTSC-61B	448815
Green	KTSC-62G	448826	KTSC-61G	448816
Ivory	KTSC-62I	448829	KTSC-61I	448819
Dimensions (mm)	Dia. 4.5 H. 5.5		W. 4, D. 4 H. 5.5	

CAPS for 12 x 12mm tactile switches

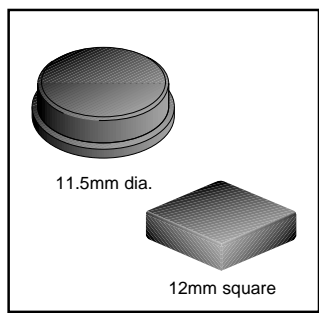

Style	Round - 11.5mm dia.		Square - 12 x 12mm	
Designed to fit	12 x 12mm square button tactile switches			
Suitable switches*	448121, 448121B, ST121 & ST121R			
Colour	Manf. Part No.	Anglia Order Code	Manf. Part No.	Anglia Order Code
Black	KTSC-22K	448920	KTSC-21K	448910
Red	KTSC-22R	448922	KTSC-21R	448912
Yellow	KTSC-22Y	448924	KTSC-21Y	448914
Blue	KTSC-22B	448925	KTSC-21B	448915
Green	KTSC-22G	448926	KTSC-21G	448916
Ivory	KTSC-22I	448929	KTSC-21I	448919
Dimensions (mm)	Dia. 11.5 (13 at base) H. 5.7 inc.1.5 for base		W. 12, D.12 H. 4.0	

* Suitable tactile switches appear on the following pages :
 448061/A & 448070/A - page 565
 448061AT - page 567
 448121 & 448121B - page 569
 ST061/B/C - page 564
 ST121 & ST121R - page 568

PRE-ASSEMBLED DIPTRONICS TACTILE SWITCHES & CAPS AVAILABLE TO SPECIAL ORDER

OKO type KSW1S, KSW2S

A range of low profile, surface mount DIL switches offering a choice of poles in two styles. Gold plated SPST contacts are designed to ensure stable operation and are housed in black moulded bodies, flame retardant to UL94V-0. KSW1S series are tape sealed to withstand wave soldering and pcb washing. Supplied in sticks, with the option of reels on the top slide switch.

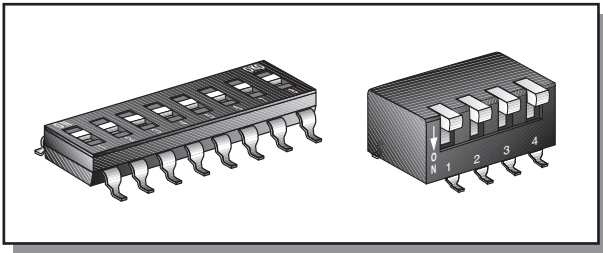

- ◆ **Surface mount**
- ◆ Choice of **two styles**
- ◆ High stability gold plated **SPST** wiping contacts
- ◆ **Low profile**, flame retardant Nylon bodies
- ◆ Tape sealed (KSW1S)
- ◆ Tinned terminations
- ◆ Body colour **Black**



Specification

Contact rating	
non-switching.....	100mA, 50Vdc
switching.....	25mA, 24Vdc
Contact resistance	
initial	50mΩ max.
after life test	100mΩ max.
Operating force	1000g max.
Insulation resistance	1000MΩ at 100Vdc
Dielectric strength	500Vdc for 1 minute

Operating temperature range	-30°C to +85°C
Life expectancy	
mechanical	3,000 operations per pole
electrical	2,000 operations per pole
Performance tests	
terminal solderability	3 sec max. at 230°C
vibration.....	to MIL-STD-202F method 204D
Initial switch position.....	All positions 'on' (top slide) 'off' (piano key)

TOP SLIDE ACTUATOR - type KSW1S

Low profile "IC package" body with flush actuators. Top tape sealed. Choice of packaging method.

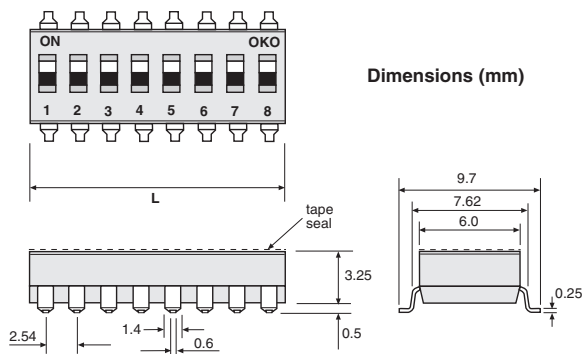

PIANO KEY ACTUATOR - type KSW2S

Low profile body with extended piano key actuators. Supplied in sticks.

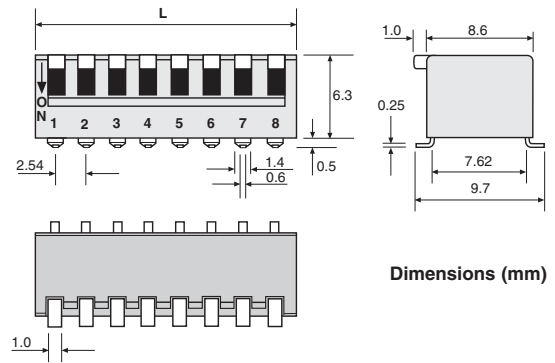

Type	Length (L) (mm)	STICK	
		Manf. Part No. & Anglia Order Code	Manf. Part No. & Anglia Order Code
2 Pole on-off	5.08	KSW1S02T	KSW1S02TT
3 Pole on-off	7.62	KSW1S03T	KSW1S03TT
4 Pole on-off	10.90	KSW1S04T	KSW1S04TT
5 Pole on-off	13.44	KSW1S05T	KSW1S05TT
6 Pole on-off	15.98	KSW1S06T	KSW1S06TT
7 Pole on-off	18.52	KSW1S07T	KSW1S07TT
8 Pole on-off	21.06	KSW1S08T	KSW1S08TT
9 Pole on-off	23.60	KSW1S09T	KSW1S09TT
10 Pole on-off	26.14	KSW1S10T	KSW1S10TT
12 Pole on-off	31.22	KSW1S12T	KSW1S12TT

Type	Length (L) (mm)	STICK	
		Manf. Part No. & Anglia Order Code	Manf. Part No. & Anglia Order Code
2 Pole on-off	6.08	KSW2S02R	KSW2S02R
3 Pole on-off	8.62	KSW2S03R	KSW2S03R
4 Pole on-off	11.90	KSW2S04R	KSW2S04R
5 Pole on-off	14.44	KSW2S05R	KSW2S05R
6 Pole on-off	16.98	KSW2S06R	KSW2S06R
7 Pole on-off	19.52	KSW2S07R	KSW2S07R
8 Pole on-off	22.06	KSW2S08R	KSW2S08R
9 Pole on-off	24.60	KSW2S09R	KSW2S09R
10 Pole on-off	27.14	KSW2S10R	KSW2S10R

● RAISED ACTUATORS available to special order

Through Hole DIL Switches shown overleaf > > >

OKO type KSW1H, KSW2H

A range of high quality, yet cost effective, low profile DIL switches offering a choice of poles in two styles. Gold plated SPST contacts are designed to ensure stable operation and are housed in black moulded bodies, flame retardant to UL94V-0. Bases are sealed to prevent flux contamination. Ideal for applications such as data processing, communications, remote controls and burglar alarm systems. Supplied in tubes.

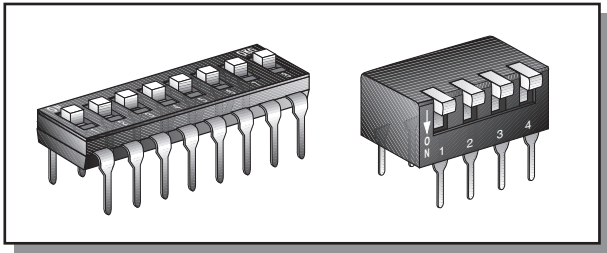

- ◆ Through hole terminals
- ◆ Choice of **two styles**
- ◆ High stability gold plated **SPST** wiping contacts
- ◆ **Low profile**, flame retardant Nylon bodies
- ◆ Sealed bases
- ◆ Gold plated terminations
- ◆ Body colour **Black**



Specification

Contact rating	
non-switching.....	100mA, 50Vdc
switching.....	25mA, 24Vdc
Contact resistance	
initial	50mΩ max.
after life test	100mΩ max.
Operating force.....	1000g max.
Insulation resistance	1000MΩ at 100Vdc
Dielectric strength	500Vdc for 1 minute

Operating temperature range.....	-30°C to +85°C
Life expectancy	
mechanical	3,000 operations per pole
electrical	2,000 operations per pole
Performance tests	
terminal solderability	5 sec max. at 260°C
vibration.....	to MIL-STD-202F method 204D
Initial switch position.....	All positions 'on' (top slide) 'off' (piano key)

● **AUTO-INSERTABLE SPLAYED TERMINALS** available to special order

TOP SLIDE ACTUATOR - type KSW1H

Low profile "IC package" body with raised actuators.

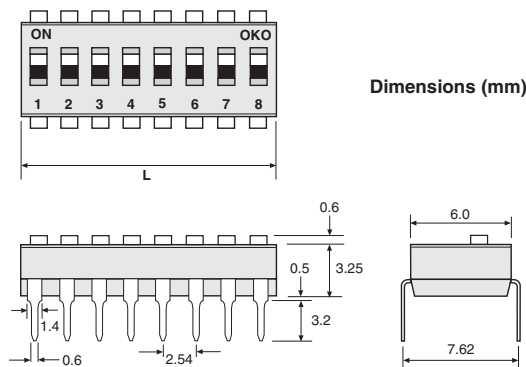

Type	Length (L) (mm)	Manf. Part No. & Anglia Order Code
2 Pole on-off	5.08	KSW1H02R
3 Pole on-off	7.62	KSW1H03R
4 Pole on-off	10.90	KSW1H04R
5 Pole on-off	13.44	KSW1H05R
6 Pole on-off	15.98	KSW1H06R
7 Pole on-off	18.52	KSW1H07R
8 Pole on-off	21.06	KSW1H08R
9 Pole on-off	23.60	KSW1H09R
10 Pole on-off	26.14	KSW1H10R
12 Pole on-off	31.22	KSW1H12R

PIANO KEY ACTUATOR - type KSW2H

Low profile body with extended piano key actuators.

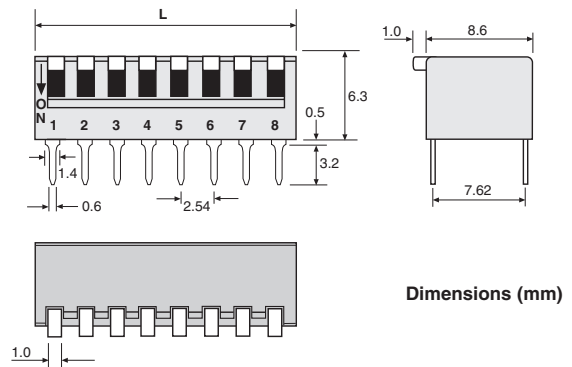

Type	Length (L) (mm)	Manf. Part No. & Anglia Order Code
2 Pole on-off	6.08	KSW2H02R
3 Pole on-off	8.72	KSW2H03R
4 Pole on-off	11.90	KSW2H04R
5 Pole on-off	14.44	KSW2H05R
6 Pole on-off	16.98	KSW2H06R
7 Pole on-off	19.52	KSW2H07R
8 Pole on-off	22.06	KSW2H08R
9 Pole on-off	24.60	KSW2H09R
10 Pole on-off	27.14	KSW2H10R

● **FLUSH ACTUATORS, WITH OR WITHOUT TAPE SEALING** available to special order

EXCEL type EDG, EPG

A range of good quality, yet highly cost effective DIL switches offering a choice of poles in two styles. Gold plated SPST wiping contacts are housed in blue moulded bodies, flame retardant to UL94V-0, with epoxy sealed bases to prevent flux contamination. Ideal for applications such as data processing, communications, remote controls and burglar alarm systems. Supplied in tubes.

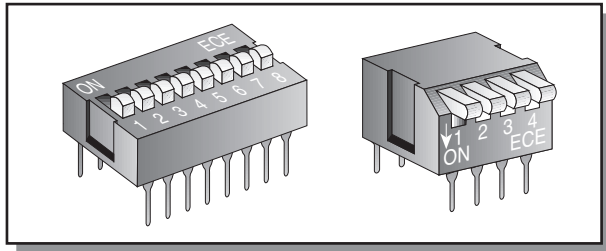

- ◆ Through hole terminals
- ◆ Cost effective
- ◆ Choice of **two styles**
- ◆ Gold plated **SPST** wiping contacts
- ◆ Flame retardant bodies
- ◆ Sealed bases
- ◆ Body colour **Blue**

Specification

Contact rating..... Non-switching, 100mA, 50Vdc
 Switching, 25mA, 24Vdc
 Contact resistance 50mΩ max. (initial)
 100mΩ max. (after life test)
 Operating force 800g max.
 Insulation resistance 1000MΩ min. at 100Vdc
 Dielectric strength 500Vdc for 1 minute

Operating temperature range -25°C to +70°C
 Life expectancy..... 3,000 operations per pole
 Performance tests:
 Terminal solderability..... 95% cover after 5 sec at 230°C
 Terminal heat shock 260°C for 5 sec
 Vibration to MIL-STD-202F method 204D
 Initial switch position..... All positions 'on' (top slide)
 'off' (piano key)

TOP SLIDE ACTUATOR - type EDG

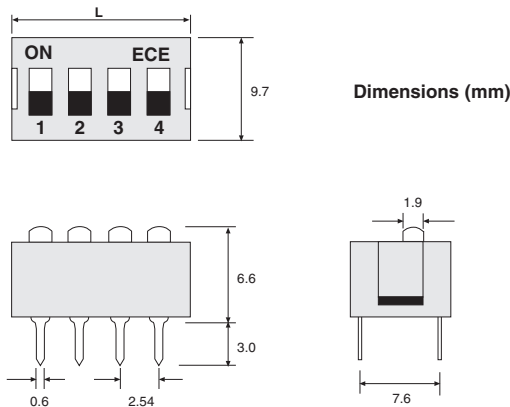

PIANO KEY ACTUATOR - type EPG

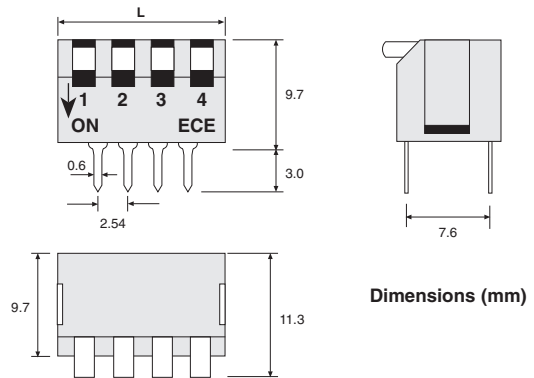

Type	Length (mm)	Manf. Part No.	Anglia Order Code
1 Pole on-off	3.9	EDG101S	447001A
2 Pole on-off	6.7	EDG102S	447002A
3 Pole on-off	9.2	EDG103S	447003A
4 Pole on-off	11.7	EDG104S	447004A
5 Pole on-off	14.2	EDG105S	447005A
6 Pole on-off	16.7	EDG106S	447006A
7 Pole on-off	19.2	EDG107S	447007A
8 Pole on-off	21.7	EDG108S	447008A
9 Pole on-off	24.2	EDG109S	447009A
10 Pole on-off	26.7	EDG110S	447010A
12 Pole on-off	31.8	EDG112S	447012A

Type	Length (mm)	Manf. Part No.	Anglia Order Code
2 Pole on-off	6.7	EPG102A	447102A
3 Pole on-off	9.2	EPG103A	447103A
4 Pole on-off	11.7	EPG104A	447104A
5 Pole on-off	14.2	EPG105A	447105A
6 Pole on-off	16.7	EPG106A	447106A
7 Pole on-off	19.2	EPG107A	447107A
8 Pole on-off	21.7	EPG108A	447108A
9 Pole on-off	24.2	EPG109A	447109A
10 Pole on-off	26.7	EPG110A	447110A
12 Pole on-off	31.8	EPG112A	447112A

TAPE SEALED SWITCHES available to special order

EXCEL type ERD

A range of miniature, surface mount, rotary switches with BCD or hexadecimal encoding. Screwdriver adjustment with gold plated contacts housed in black moulded bodies, flame retardant to UL94V-0. Fully sealed construction. Choice of stick or tape and reel packaging.

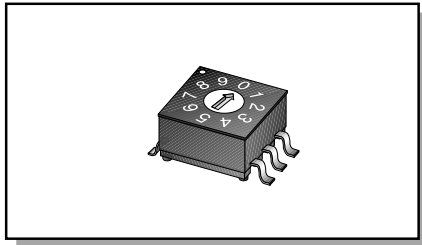

- ◆ **Surface mount**
- ◆ **BCD or Hexadecimal real codes**
- ◆ Option of 8 or 10 position BCD
- ◆ Screwdriver adjust
- ◆ Flame retardant bodies
- ◆ **Fully sealed**
- ◆ Supplied in sticks or taped & reeled
- ◆ Body colour **Black**

Specification

Contact rating..... Non-switching, 100mA, 50Vdc
 Switching, 25mA, 24Vdc
 Contact resistance..... 100mΩ max. at 5Vdc, 10mA
 Operating force 500g max.
 Insulation resistance 100MΩ min. at 100Vdc
 Dielectric strength 250Vac for 1 minute

Operating temp. range -25°C to +70°C
 Life expectancy 10,000 cycles min.
Performance tests
 Terminal solderability 95% cover after 5 sec at 230°C
 Terminal heat shock..... 260°C for 10 sec, 280°C for 2 sec
 (resistant to IR reflow soldering heat)
 Vibration..... to MIL-STD-202F method 204D

Choice of packaging method.

STICK

Type	Positions	Anglia Order Code
BCD	8	SR008
BCD	10	SR010
Hexadecimal	16	SR016



TAPE & REEL

Type	Positions	Anglia Order Code
BCD	8	SR008TR
BCD	10	SR010TR
Hexadecimal	16	SR016TR



CODING TABLE

Position \ Pins	8	4	2	1
0	0	0	0	0
1	0	0	0	1
2	0	0	1	0
3	0	0	1	1
4	0	1	0	0
5	0	1	0	1
6	0	1	1	0
7	0	1	1	1
8 pos.				
8	1	0	0	0
9	1	0	0	1
10 pos.				
A	1	0	1	0
B	1	0	1	1
C	1	1	0	0
D	1	1	0	1
E	1	1	1	0
F	1	1	1	1
16 pos.				

COMPLEMENTARY code types are available to special order

Dimensions (mm) & Connections

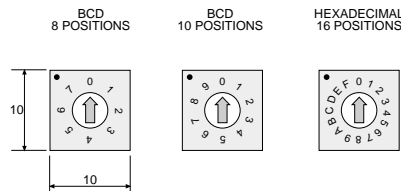
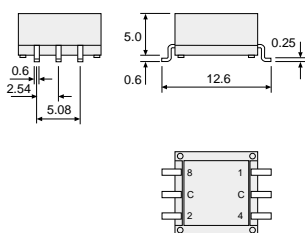

Pad Pattern

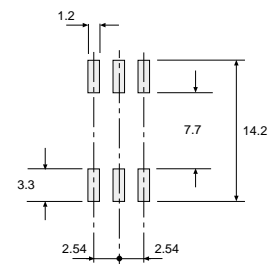

EXCEL type ERD

A range of miniature, through hole, rotary switches with BCD or hexadecimal encoding. Gold plated contacts are housed in blue moulded bodies, flame retardant to UL94V-0. Fully sealed construction. Choice of screwdriver or finger adjustment with optional spindle cover available (coloured white) to aid position identification. Switches supplied in tubes.

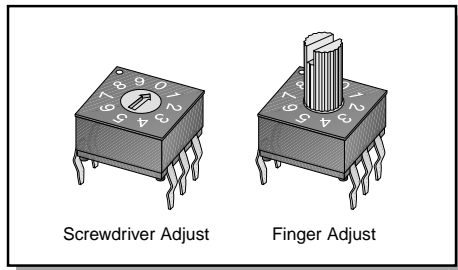

- ◆ Through hole terminals
- ◆ BCD or Hexadecimal real codes
- ◆ Option of 8 or 10 position BCD
- ◆ Screwdriver or finger adjust
- ◆ Optional spindle cover aids position identification
- ◆ Flame retardant bodies
- ◆ Fully sealed
- ◆ Body colour Blue

Specification

Contact rating..... Non-switching, 100mA, 50Vdc
 Switching, 25mA, 24Vdc
 Contact resistance..... 100mΩ max. at 5Vdc, 10mA
 Operating force 500g max.
 Insulation resistance 100MΩ min. at 100Vdc
 Dielectric strength 250Vac for 1 minute

Operating temp. range -25°C to +70°C
 Life expectancy 10,000 cycles min.
 Performance tests
 Terminal solderability 95% cover after 5 sec at 230°C
 Terminal heat shock 260°C for 10 sec, 280°C for 2 sec
 (resistant to IR reflow soldering heat)
 Vibration to MIL-STD-202F method 204D

Choice of adjustment method.

SCREWDRIVER ADJUST

Type	Positions	Anglia Order Code
BCD	8	447501A
BCD	10	447505A
Hexadecimal	16	447509A

FINGER ADJUST

Type	Positions	Anglia Order Code
BCD	8	447515A
BCD	10	447519A
Hexadecimal	16	447525A
Spindle Cover		447500A

CODING TABLE

Position \ Pins	8	4	2	1
0	0	0	0	0
1	0	0	0	1
2	0	0	1	0
3	0	0	1	1
4	0	1	0	0
5	0	1	0	1
6	0	1	1	0
7	0	1	1	1
8 pos.				
8	1	0	0	0
9	1	0	0	1
10 pos.				
A	1	0	1	0
B	1	0	1	1
C	1	1	0	0
D	1	1	0	1
E	1	1	1	0
F	1	1	1	1
16 pos.				

COMPLEMENTARY code types are available to special order

Dimensions (mm) & Connections

