

DS15BA101

1.5 Gbps Differential Buffer with Adjustable Output Voltage

General Description

The DS15BA101 is a high-speed differential buffer for cable driving, level translation, signal buffering, and signal repeating applications. Its fully differential signal path ensures exceptional signal integrity and noise immunity and it drives both differential and single-ended transmission lines at data rates up to 1.5 Gbps.

Output voltage amplitude is adjustable via a single external resistor for level translation and cable driving applications into 50-ohm single-ended and 100-ohm differential mode impedances.

The DS15BA101 is powered from a single 3.3V supply and consumes 150 mW (typ) at 1.5 Gbps. The DS15BA101 operates over the full -40°C to $+85^{\circ}\text{C}$ industrial temperature range and is available in a space saving 3x3 mm LLP-8 package.

Features

- Data rates from DC to 1.5 Gbps
- Differential or single-ended input
- Adjustable output amplitude
- Single 3.3V supply
- Industrial -40°C to $+85^{\circ}\text{C}$ temperature
- Low power: 150 mW (typ) at 1.5 Gbps
- Space-saving 3 x 3 mm LLP-8 package

Applications

- Cable extension applications
- Level translation
- Signal buffering and repeating
- Digital routers and switches
- Sonet/SDH and ATM interfaces
- Set top boxes
- Security cameras

Typical Application

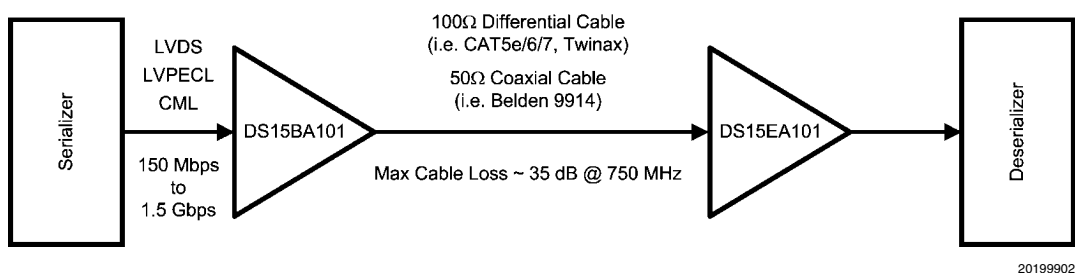

Absolute Maximum Ratings (Note 1)

| | |
|---------------------------------------|------------------------|
| Supply Voltage: | –0.5V to 3.6V |
| Input Voltage (all inputs) | –0.3V to $V_{CC}+0.3V$ |
| Output Current | 28 mA |
| Storage Temperature Range | –65°C to +150°C |
| Junction Temperature | +150°C |
| Lead Temperature (Soldering 4 Sec) | +260°C |
| Package Thermal Resistance | |
| θ_{JA} LLP-8 | +90.7°C/W |
| θ_{JC} LLP-8 | +41.2°C/W |

ESD Rating (HBM)

5 kV

ESD Rating (MM)

250V

Recommended Operating ConditionsSupply Voltage ($V_{CC} - GND$):3.3V $\pm 5\%$ Operating Free Air Temperature (T_A)

DS15BA101SD

–40°C to +85°C

DC Electrical Characteristics

Over Supply Voltage and Operating Temperature ranges, unless otherwise specified (Notes 2, 3).

| Symbol | Parameter | Conditions | Reference | Min | Typ | Max | Units |
|-----------|----------------------------------|--|------------|------------------|--------------------|---------------------|-------------------|
| V_{ICM} | Input Common Mode Voltage | | IN+, IN- | 1.6 + $V_{ID}/2$ | | $V_{CC} - V_{ID}/2$ | V |
| V_{ID} | Differential Input Voltage Swing | | | 100 | | 2000 | mV _{P-P} |
| V_{OS} | Output Common Mode Voltage | | OUT+, OUT- | | $V_{CC} - V_{OUT}$ | | V |
| V_{OUT} | Output Voltage | Single-ended, 50 Ω load, $R_{VO} = 953\Omega$ 1%, | | | 400 | | mV _{P-P} |
| | | Single-ended, 50 Ω load, $R_{VO} = 487\Omega$ 1%, | | | 800 | | mV _{P-P} |
| I_{CC} | Supply Current | (Note 5) | | | 45 | 49 | mA |

AC Electrical Characteristics

Over Supply Voltage and Operating Temperature ranges, unless otherwise specified (Note 3).

| Symbol | Parameter | Conditions | Reference | Min | Typ | Max | Units |
|------------|------------------------------------|---------------------|------------|------|------|------|-------------------|
| DR_{MAX} | Maximum Data Rate | (Note 4) | IN+, IN- | 1.5 | 2.0 | | Gbps |
| t_{LHT} | Output Low to High Transition Time | 20% – 80%, (Note 6) | OUT+, OUT- | | 120 | 220 | ps |
| t_{HLT} | Output High to Low Transition Time | | | | 120 | 220 | ps |
| t_{PLHD} | Propagation Low to High Delay | (Note 4) | | 0.95 | 1.10 | 1.35 | ns |
| t_{PHLD} | Propagation High to Low Delay | (Note 4) | | 0.95 | 1.10 | 1.35 | ns |
| t_{TJ} | Total Jitter | 1.5 Gbps | | | 26 | | ps _{P-P} |

Note 1: "Absolute Maximum Ratings" are those parameter values beyond which the life and operation of the device cannot be guaranteed. The stating herein of these maximums shall not be construed to imply that the device can or should be operated at or beyond these values. The table of "Electrical Characteristics" specifies acceptable device operating conditions.

Note 2: Current flow into device pins is defined as positive. Current flow out of device pins is defined as negative. All voltages are stated referenced to GND.

Note 3: Typical values are stated for $V_{CC} = +3.3V$ and $T_A = +25^\circ C$.

Note 4: Specification is guaranteed by characterization.

Note 5: Maximum I_{CC} is measured at $V_{CC} = +3.465V$ and $T_A = +70^\circ C$.

Note 6: Specification is guaranteed by characterization and verified by test.

Connection Diagram

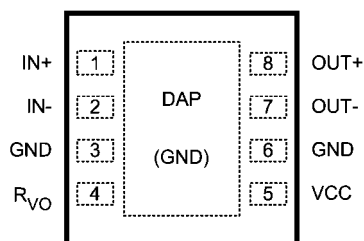

20199901

8-Pad LLP

Order Number DS15BA101SD or DS15BA101SDX
See NS Package Number SDA08A

Pin Descriptions

| Pin # | Name | Description |
|-------|-----------------|--|
| 1 | IN+ | Non-inverting input pin. |
| 2 | IN- | Inverting input pin. |
| 3 | GND | Circuit common (ground reference). |
| 4 | R _{VO} | Output voltage amplitude control. Connect a resistor to V _{CC} to set output voltage. |
| 5 | V _{CC} | Positive power supply (+3.3V). |
| 6 | GND | Circuit common (ground reference). |
| 7 | OUT- | Non-inverting output pin. |
| 8 | OUT+ | Inverting output pin. |

Device Operation

INPUT INTERFACING

The DS15BA101 accepts either differential or single-ended input. The inputs are self-biased, allowing for simple AC or DC coupling. DC-coupled inputs must be kept within the specified common-mode range. The IN+ and IN- are self-biased at approximately 2.1V with V_{CC} = 3.3V.

OUTPUT INTERFACING

The DS15BA101 uses current mode outputs. Single-ended output levels are 400 mV_{P-P} into AC-coupled 100Ω differential

cable (with R_{VO} = 953Ω) or into AC-coupled 50Ω coaxial cable (with R_{VO} = 487Ω). Output level is controlled by the value of the R_{VO} resistor connected between the R_{VO} and V_{CC}.

The R_{VO} resistor should be placed as close as possible to the R_{VO} pin. In addition, the copper in the plane layers below the R_{VO} network should be removed to minimize parasitic capacitance.

Physical Dimensions inches (millimeters) unless otherwise noted

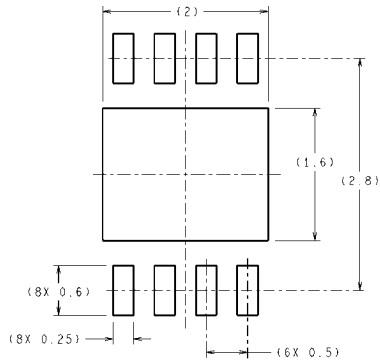

RECOMMENDED LAND PATTERN

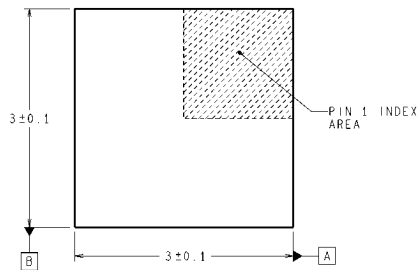

DIMENSIONS ARE IN MILLIMETERS
DIMENSIONS IN () FOR REFERENCE ONLY

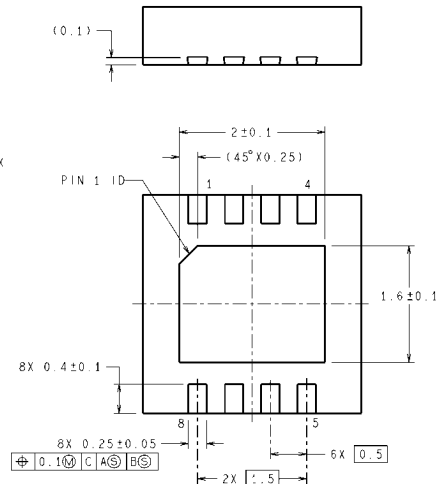
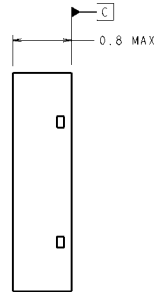

SDA08A (Rev A)

8-Pad LLP
Order Number DS15BA101SD or DS15BA101SDX
NS Package Number SDA08A

Notes

Notes

THE CONTENTS OF THIS DOCUMENT ARE PROVIDED IN CONNECTION WITH NATIONAL SEMICONDUCTOR CORPORATION ("NATIONAL") PRODUCTS. NATIONAL MAKES NO REPRESENTATIONS OR WARRANTIES WITH RESPECT TO THE ACCURACY OR COMPLETENESS OF THE CONTENTS OF THIS PUBLICATION AND RESERVES THE RIGHT TO MAKE CHANGES TO SPECIFICATIONS AND PRODUCT DESCRIPTIONS AT ANY TIME WITHOUT NOTICE. NO LICENSE, WHETHER EXPRESS, IMPLIED, ARISING BY ESTOPPEL OR OTHERWISE, TO ANY INTELLECTUAL PROPERTY RIGHTS IS GRANTED BY THIS DOCUMENT.

TESTING AND OTHER QUALITY CONTROLS ARE USED TO THE EXTENT NATIONAL DEEMS NECESSARY TO SUPPORT NATIONAL'S PRODUCT WARRANTY. EXCEPT WHERE MANDATED BY GOVERNMENT REQUIREMENTS, TESTING OF ALL PARAMETERS OF EACH PRODUCT IS NOT NECESSARILY PERFORMED. NATIONAL ASSUMES NO LIABILITY FOR APPLICATIONS ASSISTANCE OR BUYER PRODUCT DESIGN. BUYERS ARE RESPONSIBLE FOR THEIR PRODUCTS AND APPLICATIONS USING NATIONAL COMPONENTS. PRIOR TO USING OR DISTRIBUTING ANY PRODUCTS THAT INCLUDE NATIONAL COMPONENTS, BUYERS SHOULD PROVIDE ADEQUATE DESIGN, TESTING AND OPERATING SAFEGUARDS.

EXCEPT AS PROVIDED IN NATIONAL'S TERMS AND CONDITIONS OF SALE FOR SUCH PRODUCTS, NATIONAL ASSUMES NO LIABILITY WHATSOEVER, AND NATIONAL DISCLAIMS ANY EXPRESS OR IMPLIED WARRANTY RELATING TO THE SALE AND/OR USE OF NATIONAL PRODUCTS INCLUDING LIABILITY OR WARRANTIES RELATING TO FITNESS FOR A PARTICULAR PURPOSE, MERCHANTABILITY, OR INFRINGEMENT OF ANY PATENT, COPYRIGHT OR OTHER INTELLECTUAL PROPERTY RIGHT.

LIFE SUPPORT POLICY

NATIONAL'S PRODUCTS ARE NOT AUTHORIZED FOR USE AS CRITICAL COMPONENTS IN LIFE SUPPORT DEVICES OR SYSTEMS WITHOUT THE EXPRESS PRIOR WRITTEN APPROVAL OF THE CHIEF EXECUTIVE OFFICER AND GENERAL COUNSEL OF NATIONAL SEMICONDUCTOR CORPORATION. As used herein:

Life support devices or systems are devices which (a) are intended for surgical implant into the body, or (b) support or sustain life and whose failure to perform when properly used in accordance with instructions for use provided in the labeling can be reasonably expected to result in a significant injury to the user. A critical component is any component in a life support device or system whose failure to perform can be reasonably expected to cause the failure of the life support device or system or to affect its safety or effectiveness.

National Semiconductor and the National Semiconductor logo are registered trademarks of National Semiconductor Corporation. All other brand or product names may be trademarks or registered trademarks of their respective holders.

Copyright© 2006 National Semiconductor Corporation

For the most current product information visit us at www.national.com



**National Semiconductor
Americas Customer
Support Center**
Email:
new.feedback@nsc.com
Tel: 1-800-272-9959

**National Semiconductor Europe
Customer Support Center**
Fax: +49 (0) 180-530-85-86
Email: europe.support@nsc.com
Deutsch Tel: +49 (0) 69 9508 6208
English Tel: +49 (0) 870 24 0 2171
Français Tel: +33 (0) 1 41 91 8790

**National Semiconductor Asia
Pacific Customer Support Center**
Email: ap.support@nsc.com

**National Semiconductor Japan
Customer Support Center**
Fax: 81-3-5639-7507
Email: jpn.feedback@nsc.com
Tel: 81-3-5639-7560