



# EVERLIGHT ELECTRONICS CO.,LTD.

Device Number : DLE-031-079 REV: 1.0

T-1 3/4 (4.7mm) Round Shape LED Lamps

MODEL NO : 313-2UYC/S530-A6 ECN : \_\_\_\_\_ Page: 1/4

## Features :

- 4.7mm round without flange.
- Available on tape and reel.
- Reliable and rugged.
- Improved brightness.
- Narrow viewing angle.

## Description :

- $\phi$  4.7mm T-1(3/4)all resin mold.
- General application is for indication,illumination,etc.
- The LED lamp is available with different colors,light intensities,epoxy colors,etc.

## Package Dimension:

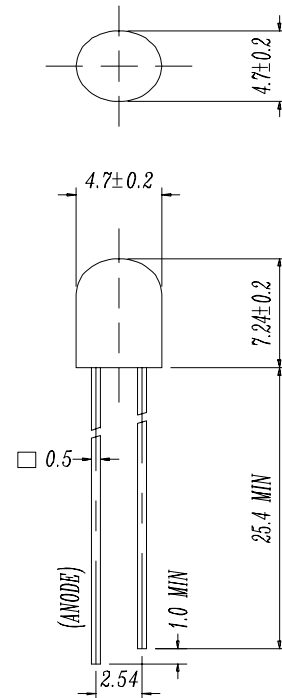

## Applications :

- TV Set
- Monitor
- Telephone
- Computer

## NOTES :

- 1.All dimensions are in millimeters.
- 2.An epoxy meniscus may extend about 1.5mm(0.059") down to the lead.

PART NO	CHIP		Lens Color
	Material	Emitted Color	
313-2UYC/S530-A6	AlGaInP	Super Yellow	Water Clear

DESIGNER	CHECKER	APPROVER

Office : NO 25,Lane 76,Chung Yang Rd,Sec.3  
Tucheng,Taipei 236,Taiwan,R.O.C.

TEL : 886-2-2267-2000,2267-9936(22 Lines)  
FAX : 886-2-2267-6189



# EVERLIGHT ELECTRONICS CO.,LTD.

Device Number : DLE-031-079 REV: 1.0

T-1 3/4 (4.7mm) Round Shape LED Lamps

MODEL NO : 313-2UYC/S530-A6 ECN : \_\_\_\_\_ Page: 2/4

## ■ Absolute Maximum Ratings at T<sub>A</sub> = 25°C

Parameter	Symbol	Rating	Unit
Forward Current	I <sub>f</sub>	25	mA
Operating Temperature	T <sub>opr</sub>	-40 to +85	°C
Storage Temperature	T <sub>stg</sub>	-40 to +100	°C
Soldering Temperature	T <sub>sol</sub>	260 ± 5	°C
Power Dissipation	P <sub>d</sub>	60	mW
Peak Forward Current(Duty 1/10 @ 1KHZ)	I <sub>f(peak)</sub>	160	mA
Reverse Voltage	V <sub>r</sub>	5	V

## ■ Electronic Optical Characteristics :

Parameter	Symbol	MIN.	TYP.	MAX.	Unit	Condition
Luminous intensity	I <sub>v</sub>	----- 860	82.8 1380	----	mcd	I <sub>f</sub> =2mA I <sub>f</sub> =20mA
Viewing Angle	2 θ 1/2	----	20	----	deg	I <sub>f</sub> =20mA
Peak Wavelength	λ <sub>p</sub>	----	591	----	nm	I <sub>f</sub> =20mA
Dominant Wavelength	λ <sub>d</sub>	----	589	----	nm	I <sub>f</sub> =20mA
Spectrum Radiation Bandwidth	Δ λ	----	15	----	nm	I <sub>f</sub> =20mA
Forward Voltage	V <sub>f</sub>	-----	2.0	2.4	V	I <sub>f</sub> =20mA
Reverse Current	I <sub>r</sub>	----	----	10	μ A	V <sub>r</sub> =5V

ESD:2000V



T-1 3/4 (4.7mm) Round Shape LED Lamps

■ Typical Electro-Optical Characteristic Curves

